

USE AND CARE BOOKLET  
**ZENITH X2 / ZENITH X2 AIR**  
**ZENITH X2 MAX / ZENITH X2 MAX AIR**  
**SAFETY HELMET FOR INDUSTRIAL USE**

ZENITH X2	SIZE 52-63 cm   6 1/2 - 7 7/8	ADJUSTABLE
ZENITH X2 AIR		
ZENITH X2 MAX	SIZE 60-66 cm   7 3/8 - 8 1/4	
ZENITH X2 MAX AIR		

### NOMENCLATURE

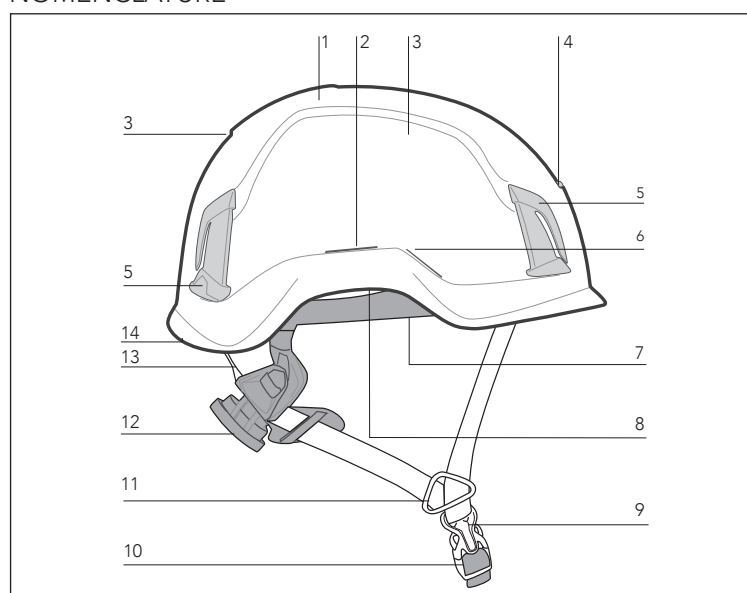

KASK S.p.A.  
 24060 Chiuduno, BG  
 Via Firenze, 5 - Italy  
 t. +39 035 4427497  
 info@kask.com  
 www.kask.com



ANSI/ISEA Z89.1-2014  
 TYPE I, TYPE II CLASS C / E

### FAC-SIMILE LABELLING

Manufacturer: KASK S.p.A. Via Firenze 5 - 24060 Chiuduno BG - Italy	Weight: 1.04 lb 470 g	Complies with requirements of the European Standard EN12492:2012 - Shock energy absorption capacity - Clauses 4.2.1.2 (front), 4.2.1.3 (lateral), 4.2.1.4 (rear); Penetration ; 4.2.2 - Retention system strength - 4.2.3; Retention system effectiveness (Roll off) - 4.2.4. www.kask.com
Model: ZENITH X2	Size: Adjustable 6 1/2 - 7 7/8 52 - 63cm	
Standard: ANSI Z89.1-2014 Type I, Type II - Class E OPTIONAL REQUIREMENT: LT - HT		

**SAFETY HELMET FOR INDUSTRIAL USE.**  
 For adequate protection this helmet has to fit or to be adjusted to the size of the user's head. The helmet is made to absorb the energy of a blow by partial destruction or damage, and even though such damage may not be readily apparent any helmet subjected to a blow must be replaced. The attention of the user is also drawn to the danger of modifying or removing any of the original component parts of the helmet, other than as recommended by the helmet manufacturer. Helmets should not be adapted for the purpose of fitting attachments in any way not recommended by the helmet manufacturer. Do not apply paint, solvents, adhesives or self-adhesive labels, except in accordance with instructions from the helmet manufacturer. For cleaning, maintenance or disinfection, use only substances that have no adverse effect on the helmet and are not known to be likely to have any adverse effect upon the wearer, when applied in accordance with the manufacturer's instructions and information.

### MARKING ON THE SHELL

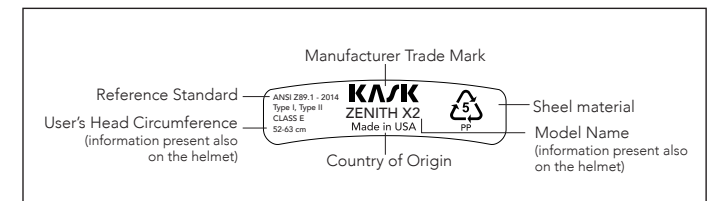

Fig 1

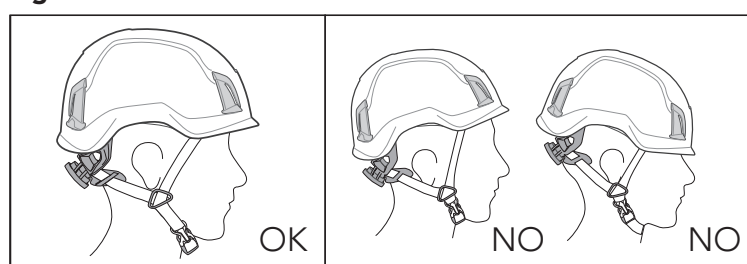

Fig 2

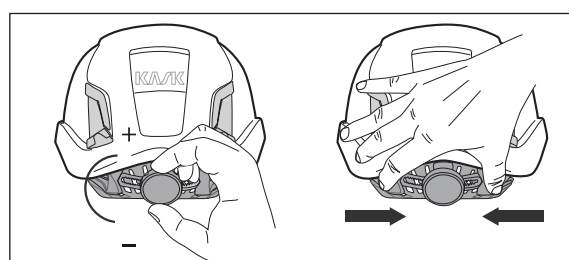

Fig 3

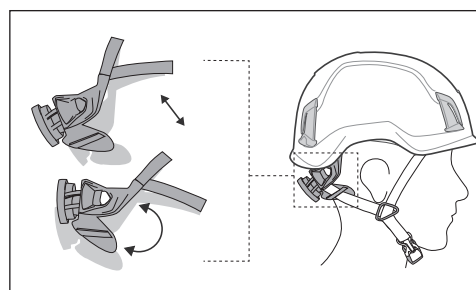
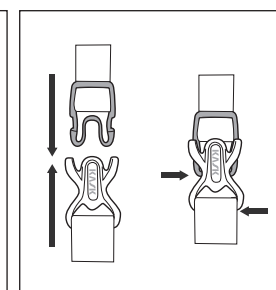

Fig 4a



4b

Fig 5

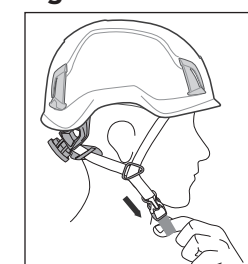

Fig 6

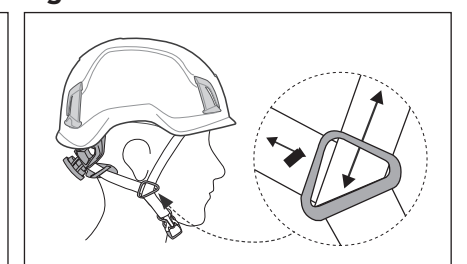

Fig 7

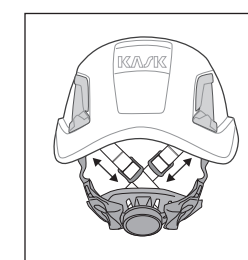

Fig 8 - DATE OF MANUFACTURE

